

"A"

ESTATE OF
HENRY THOMPSON NORTH

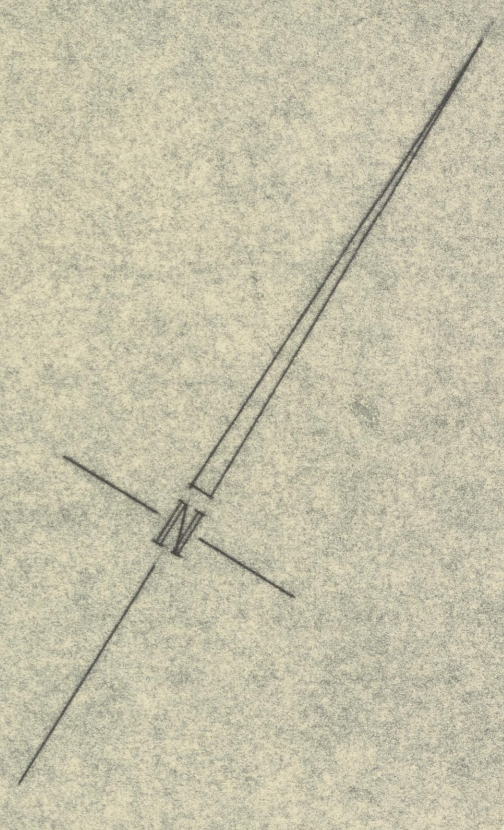

HARRINGTON & RUTH ZUILL

OLIVE SANTUCCI

BURTON SINCLAIR
TROTT

WILTON DIXON

LAURIANSTON
WILLIAMS

THURSTON SMITH

JEANETTE MCGOWEN

FROM SONNERSALL ROAD

JUDKIN LANE

AREA 1.000 ACRE

WATERS OF

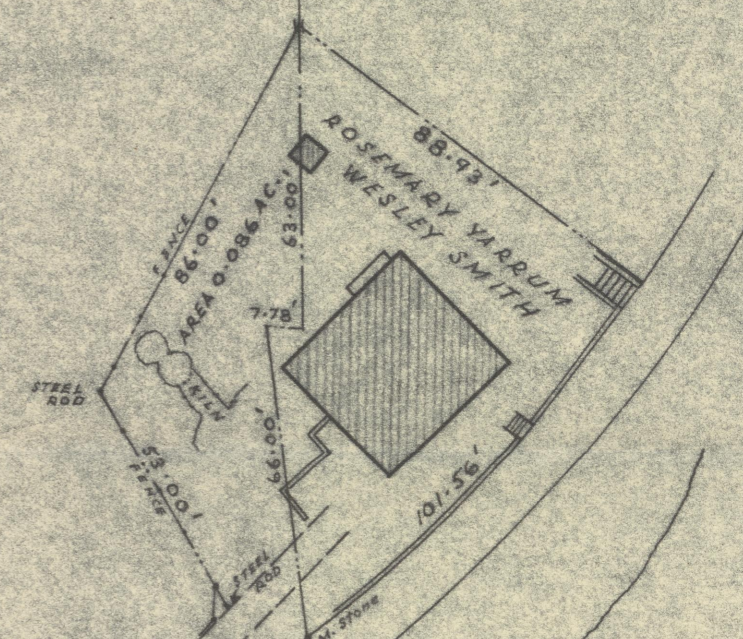

PLAN OF LAND
AT
JUDKIN LANE RD. - MANGROVE LAKE - SMITHS PARISH
BERMUDA
SCALE 40 FT. TO 1 IN.

ROBERT H. CLARKE
ENGINEER & SURVEYOR
HAMILTON BERMUDA

"B"



PLAN OF LAND
 AT
 JUDKIN LANE & SOMMERSALL RD. - MANGROVE LAKE
 SMITHS PARISH & HAMILTON PARISH
 BERMUDA

SCALE 60 FT. TO 1 IN.