

QA 1

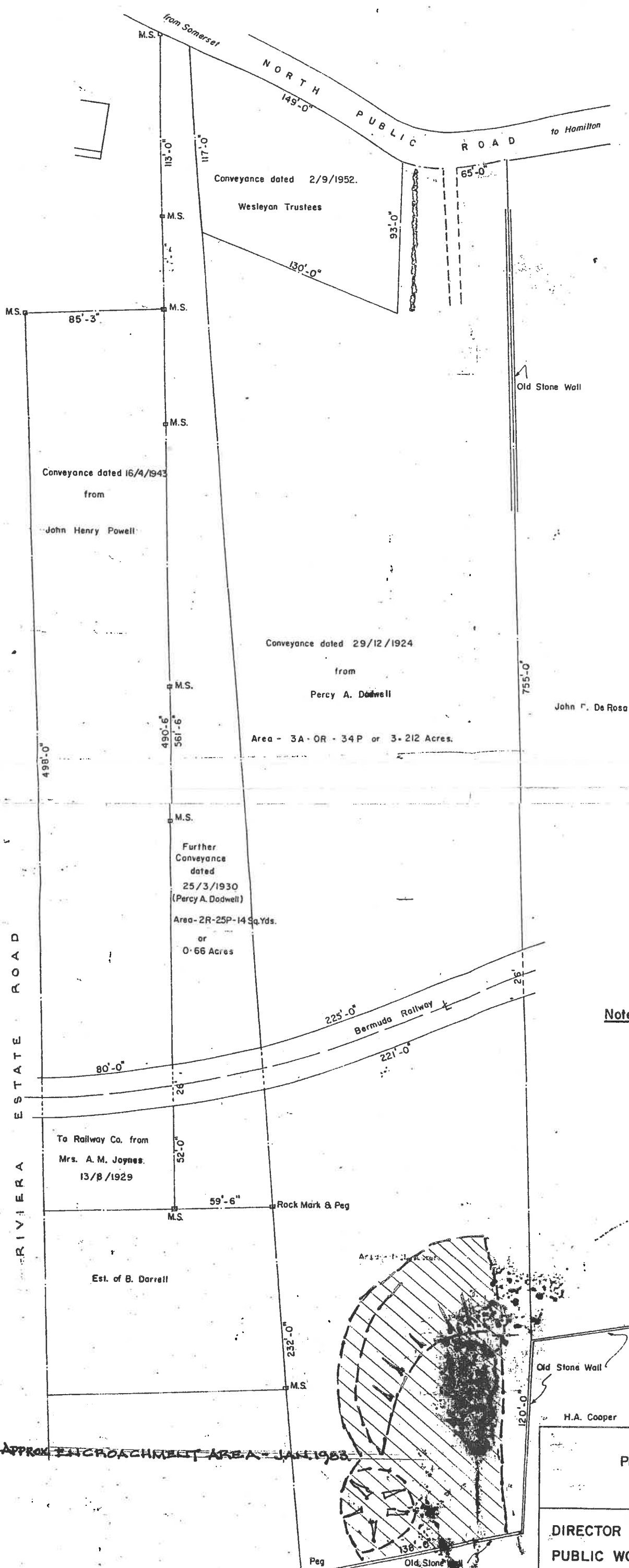

No 16 B

**Note:** Traced from plan, surveyed and drawn by J.H. of Public Works Department, dated 1/3/30.

AREA HATCHED IN RED DENOTES APPROXIMATE EXTENT OF ENCROACHMENT

PLAN OF LAND - SOUTHAMPTON PARISH  
HERON BAY SCHOOL

DIRECTOR OF PUBLIC WORKS	Scale	50' = 1"	Dwg. No. 4/9/6
	Survey Drawn	P.W.D. Q.S.	Public Works Hamilton
	Date	2/3/70	Bermuda